

BASED ON A SURVEY BY TOMKINS SURVEYING MARCH, 1998

SCALE: 1" = 20' HOR 1" = 4' VER

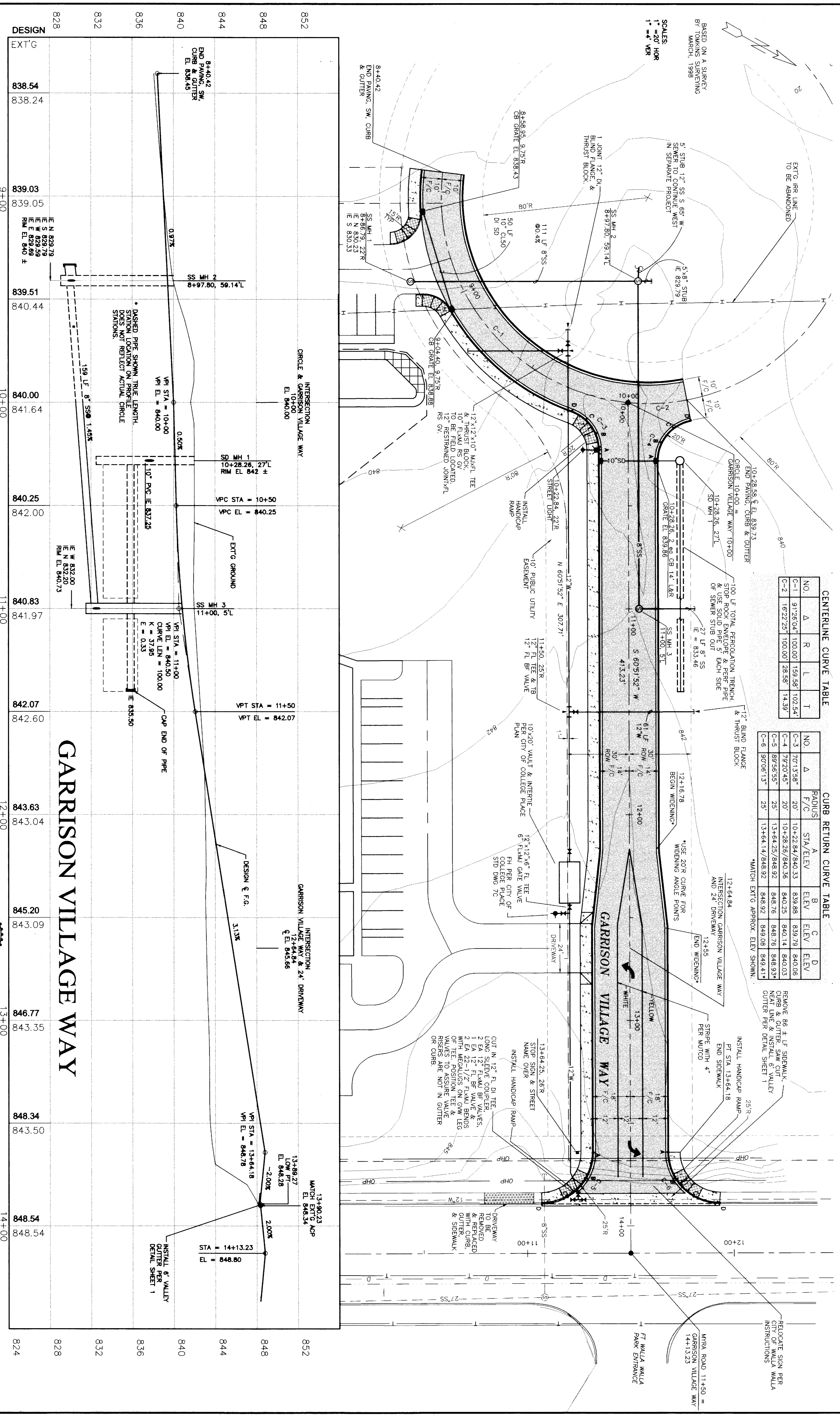

**CENTERLINE CURVE TABLE**

NO.	A	R	L	T
C-1	9126.04'	100.00'	159.58'	102.54'
C-2	1822.25'	100.00'	28.58'	14.39'

**CURB RETURN CURVE TABLE**

NO.	A	RADIUS	B	C	D
		F/C	STA/ELEV	ELEV	ELEV
C-3	7071.98'	20'	10+22.84/840.33	839.88	839.79
C-4	7920.45'	20'	10+28.26/840.36	840.25	840.14
C-5	8956.95'	25'	13+64.25/848.92	848.76	848.76
C-6	9070.61'	25'	13+64.14/848.92	848.92	849.08

\*MATCH EXT'G. APPROX. ELEV. SHOWN.

REMOVE 86 ± LF SIDEWALK, NEAR LINE & REINSTALL CULLEY CUTTER PER DETAIL SHEET 1

INSTALL HANDICAP RAMP, END SIDEWALK, STRIPE WITH 4" PER WIDTH

INSTALL HANDICAP RAMP, PT. STA. 13+64.18

RELOCATE SIGN PER CITY OF WALLA WALLA INSTRUCTIONS

MIRA ROAD 11+50 = GARRISON VILLAGE WAY 14+13.23

DESIGN	EXT'G
828	838.54
832	839.03
836	839.05
840	839.51
844	840.44
848	840.00
852	841.64
	10+00
	840.25
	842.00
	840.83
	841.97
	842.07
	842.60
	843.63
	843.04
	845.20
	843.09
	846.77
	843.35
	848.34
	843.50
	848.54
	848.54
	14+00
	824

# GARRISON VILLAGE WAY

NOTICE: THIS DRAWING IS BASED ON INFORMATION PROVIDED BY OTHERS. NOT VERIFIED THE ACCURACY AND/OR COMPLETENESS OF THIS INFORMATION AND SHALL NOT BE RESPONSIBLE FOR ANY ERRORS OR OMISSIONS WHICH MAY BE AND/OR ARE SHOWN HEREIN.

RECORD DRAWING

DATE: 06-11-98  
DRAWN BY: [Signature]  
M.A.  
DWS: NO. 061-10037

INFORMATION PROVIDED BY SHARPE & PRESZLER, INC.

**VALLEY DEVELOPMENT**  
REGENCY SITE RECORD DRAWING  
PIP GARRISON VILLAGE WAY 8+40.42 TO END

**HALL ENGINEERING ASSOCIATES**  
10 SOUTH ALBION - KENNESAW, WA 98335  
(360) 562-2200 - FAX: (360) 564-2897

# GARRISON VILLAGE WAY WATER LINE EXTENSION COLLEGE PLACE, WASHINGTON

WALLA WALLA  
VALLEY DEVELOPMENT

SCALE: 1"=100 FEET  
0 50 100 200

BASED ON A SURVEY  
BY TOMKINS SURVEYING  
MARCH, 1999

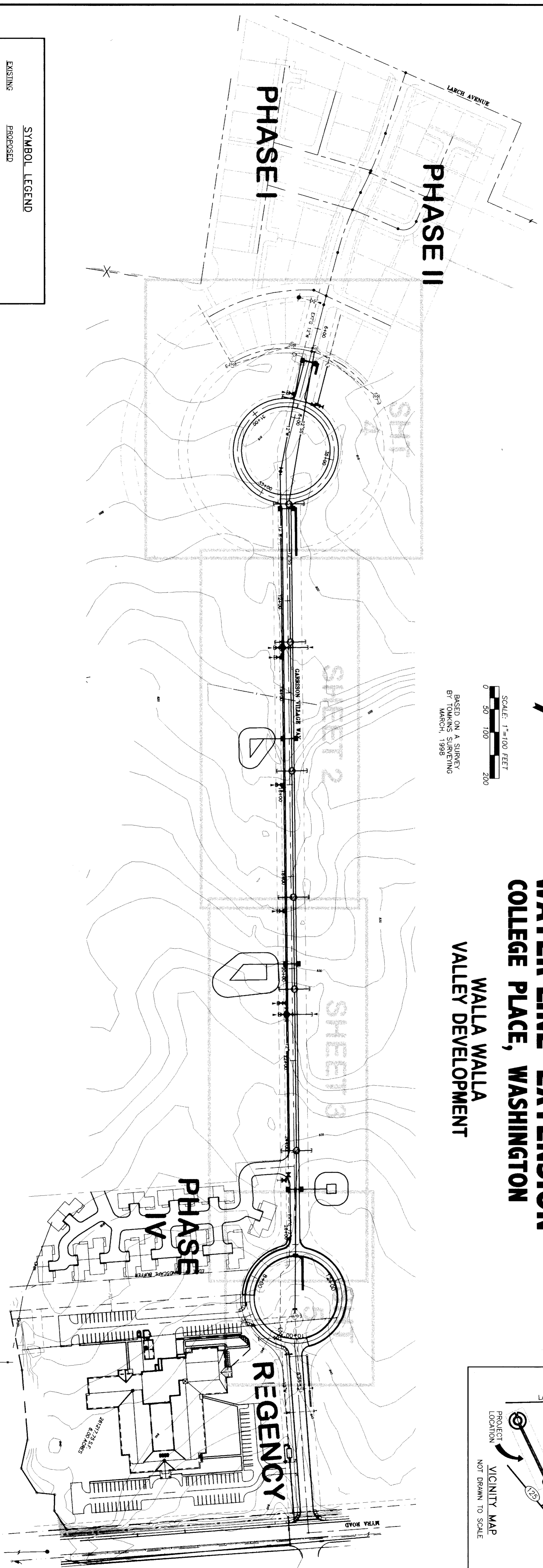
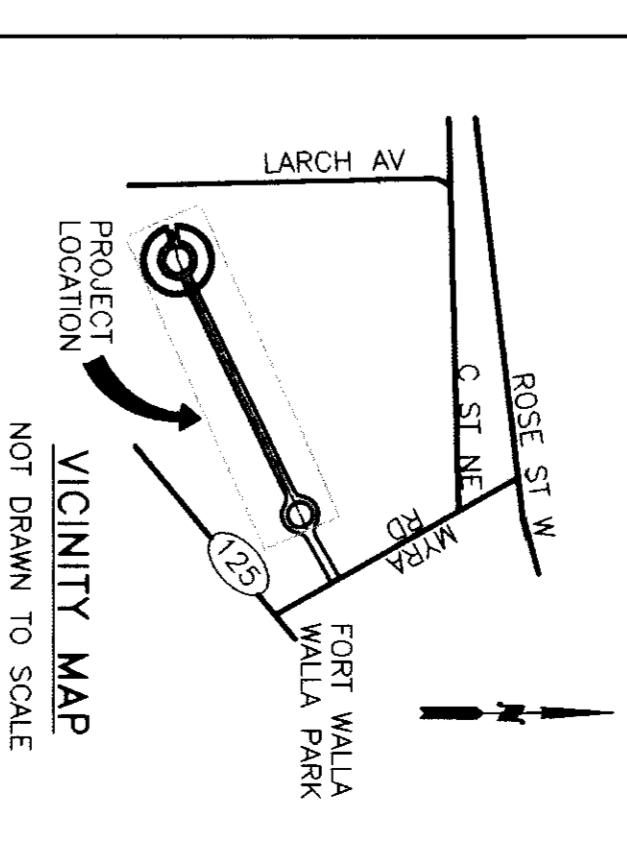

SYMBOL LEGEND	
	NEW ACP
	CURB & GUTTER
	ROW / PROP LINE
	EASEMENT
	ORIGINAL GROUND CONTOUR
	STORM DRAIN
	SAWTRAY SEWER LINE
	WATER LINE
	GAS LINE
	MONUMENT
	SAWTRAY SEWER MANHOLE
	VALVE
	FIRE HYDRANT
	THRUST BLOCK
	PIPE STUB-OUT
	BLOW OFF
	CATCH BASIN

**CONSTRUCTION NOTES**

- EXISTING UTILITIES ARE SHOWN IN APPROXIMATE LOCATIONS ONLY. CONTRACTOR SHALL NOTIFY THE UNDERGROUND UTILITY LOCATION CONTRACTOR AND VERIFY ALL UTILITY LOCATIONS PRIOR TO CONSTRUCTION.
- CONTRACTOR IS SOLELY RESPONSIBLE FOR THE MEANS, METHODS & TECHNIQUES OF CONSTRUCTION AS WELL AS MAINTAINING A SAFE WORK PLACE FOR ALL CONSTRUCTION ACTIVITIES.
- ALL WORK SHALL BE PERFORMED IN ACCORDANCE WITH THE LATEST SPECIFICATIONS AND STANDARD PLANS.
- CONTRACTOR SHALL CONTROL DUST IN ACCORDANCE WITH LOCAL AIR POLLUTION CONTROL AUTHORITY AND DEPT. OF ECOLOGY.
- CONTRACTOR IS RESPONSIBLE FOR APPLYING FOR AND OBTAINING ALL PERMITS NECESSARY. IT IS THE SOLE RESPONSIBILITY OF THE CONTRACTOR TO ADHERE TO ALL PERMIT REQUIREMENTS.
- PLACE MONUMENTS SHOWN PER CITY STD.
- CONTRACTOR SHALL PROVIDE OWNER WITH ONE SET OF PLANS SHOWING ALL CHANGES FROM THE APPROVED DESIGN DIMENSIONS AND REVISIONS FOR USE IN PREPARING CONSTRUCTION RECORD DRAWINGS.

**SEWER NOTES**

- SEWER PIPE TO BE SDR 35 PVC IN 13' JOINTS.
- TRENCH EXCAVATION & BACKFILL SHALL BE IN CONFORMANCE WITH CITY OF COLLEGE PLACE STANDARDS.
- ALL PIPE SHALL BE FULLY BEDDED WITH A MINIMUM OF 4" UNDER PIPE AND 6" OVER PIPE WITH MATERIALS PER THE STANDARD SPECIFICATIONS OR AS APPROVED BY CITY ENGINEER PRIOR TO USE.
- WHEN GROUNDWATER IS PRESENT, OVER EXCAVATE TO 12" BELOW INVERT AND BACKFILL WITH COMPACTED CLASS B FOUNDATION MATERIAL PER WSDOT 9-03.17.
- MANHOLE CONSTRUCTION IN ACCORDANCE WITH CITY OF COLLEGE PLACE STD DWG 6A.
- SEWER SERVICE CONNECTIONS SHALL BE IN ACCORDANCE WITH CITY OF COLLEGE PLACE STD DWG 6E.
- END OF ALL SEWER STUBS SHALL BE LOCATED AND MARKED WITH 12 GA COPPER TRACER WIRE.
- AIR TEST AT 5 PSI. ADDITIONALLY, ACCEPTANCE BASED ON SATISFACTORY T.V. REPORT. CONTRACTOR SHALL CALL CITY OF COLLEGE PLACE WASTEWATER DIRECTOR 48 HOURS BEFORE REQUIRED T.V. INSPECTION.

**WATER NOTES:**

- ALL CONSTRUCTION SHALL CONFORM TO THE CITY OF COLLEGE PLACE STANDARD SPECIFICATIONS.
- CONTRACTOR'S ATTENTION IS SPECIFICALLY DIRECTED TO SECTIONS PERTAINING TO:
  - THRUST BLOCKING 8, 9A & 8B
  - WATER SERVICES 70 & 7E
  - FIRE HYDRANTS 7C & 7E
  - FIRE HYDRANTS TO HAVE STORTZ ADAPTERS.
- ALL 12" W TO BE CLASS DUCTILE IRON, MECHANICAL JOINT EXCEPT 2" TO BE GALVANIZED IRON.
- PRESSURE TEST (180 PSI) ON WATER.

**INDEX OF SHEETS**

SHEET NO.	DESCRIPTION
1	COVER SHEET
2	B/P GARRISON VILLAGE WAY EXTENSION 6+00 TO 18+00
3	B/P GARRISON VILLAGE WAY EXTENSION 18+00 TO END WITH SECTION
4	P/P WEST CIRCLE WITH SECTIONS & DETAIL
5	P/P EAST CIRCLE WITH SECTION

APPROVED FOR CONSTRUCTION BY:  
  
 COLLEGE PLACE CITY ENGINEER  
 DATE: 12/1/99

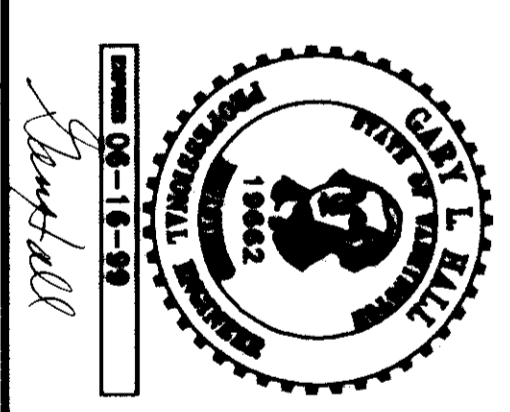

DATE: 11-19-98  
 DRAWN BY: MA  
 DWS: NO. 061-0028

SHEET 1 OF 5  
 CALL BEFORE YOU DIG (800) 332-2344

**VALLEY DEVELOPMENT**  
 GARRISON VILLAGE WAY EXTENSION  
 COVER SHEET

**HALL ENGINEERING ASSOCIATES**  
 10 SOUTH LUMBER, KENNESAW, WA 98336  
 (360) 562-2200 - FAX (360) 566-2897

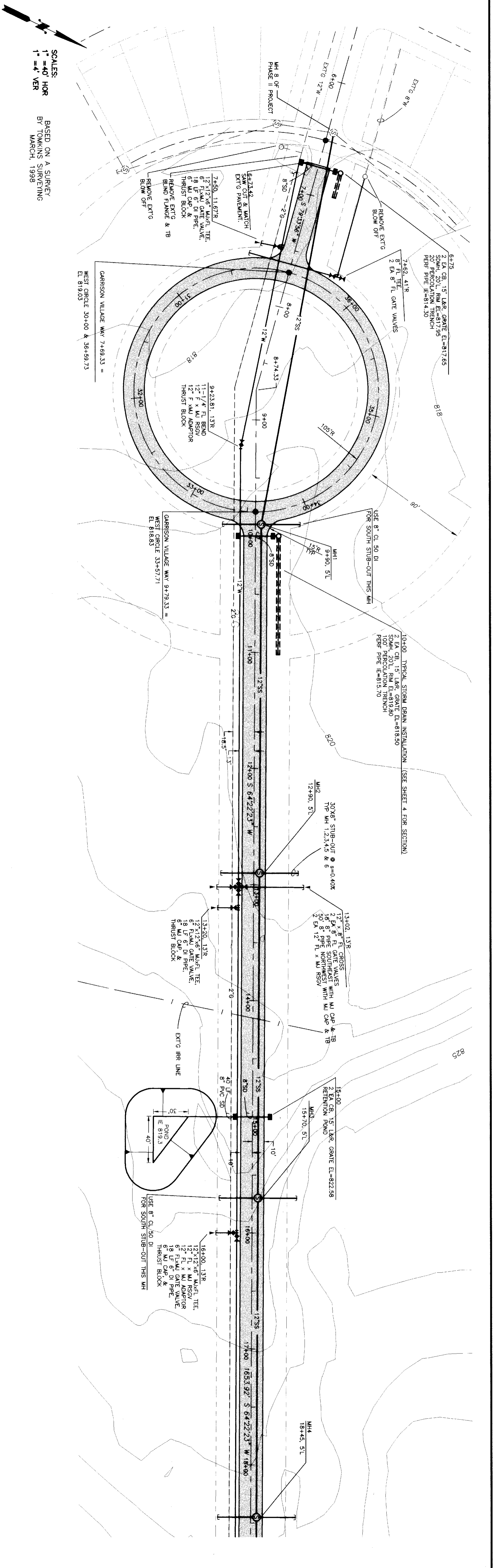

SCALES:  
 1" = 40' HOR  
 1" = 4' VER

BASED ON A SURVEY  
 BY TOMKINS SURVEYING  
 MARCH, 1998

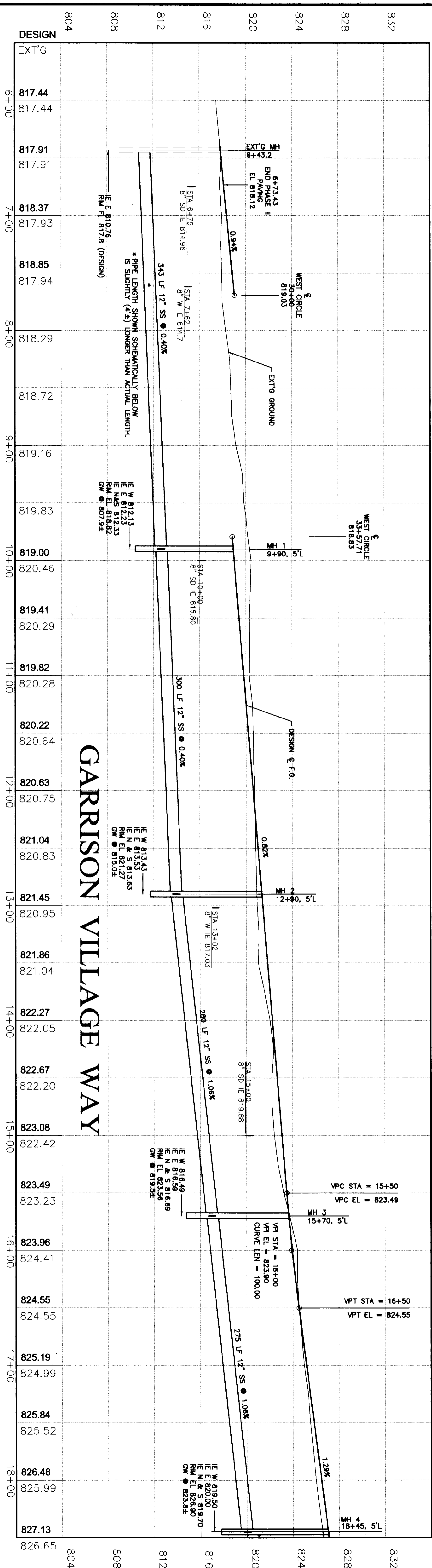

# GARRISON VILLAGE WAY

SCALES:  
 1" = 40' HOR  
 1" = 4' VER

rcp01001.dwg

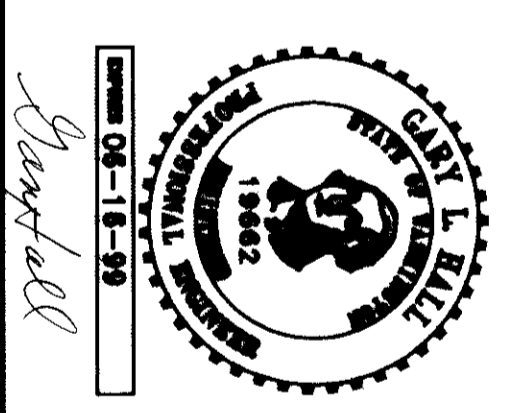
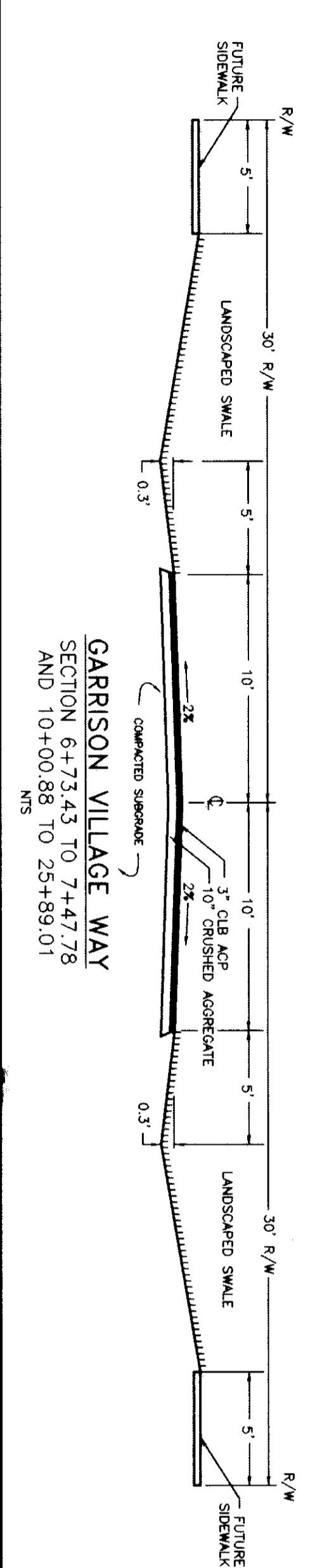

DATE: 11-19-98  
 DRAWN BY: M/TAG  
 DWG. NO.: 061-0029

**VALLEY DEVELOPMENT**  
 GARRISON VILLAGE WAY EXTENSION  
 PIP 6+00 TO 18+00

**HALL ENGINEERING ASSOCIATES**  
 10 SOUTH AUBURN - KENNESAW, WA 99336  
 (509) 582-2200 - FAX (509) 586-2897

SHEET 2 OF 5  
 CALL BEFORE YOU DIG (800) 332-4344



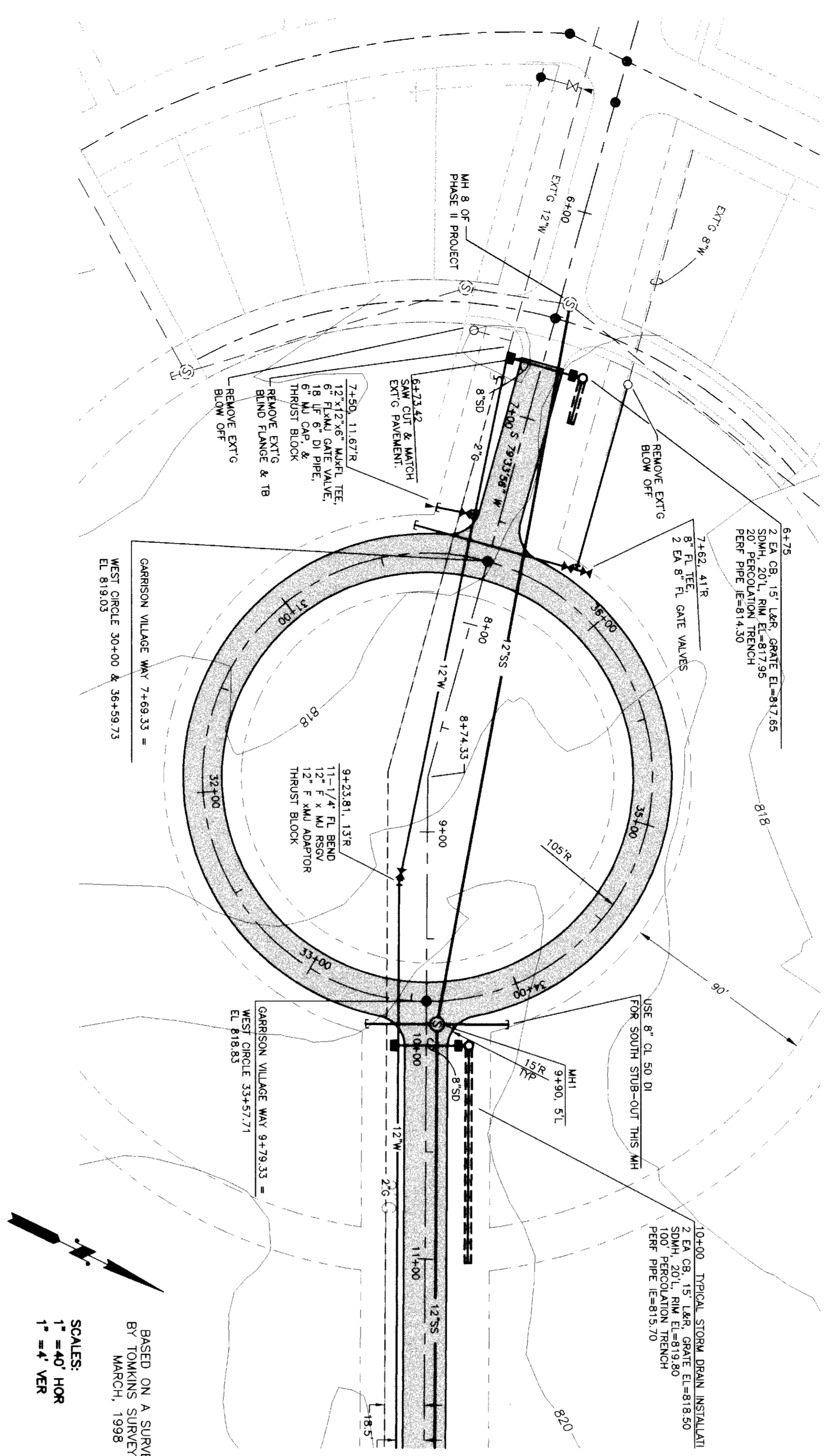

BASED ON A SURVEY  
BY TOMKINS SURVEYING  
MARCH, 1998

SCALES:  
1" = 40' HOR  
1" = 4' VER

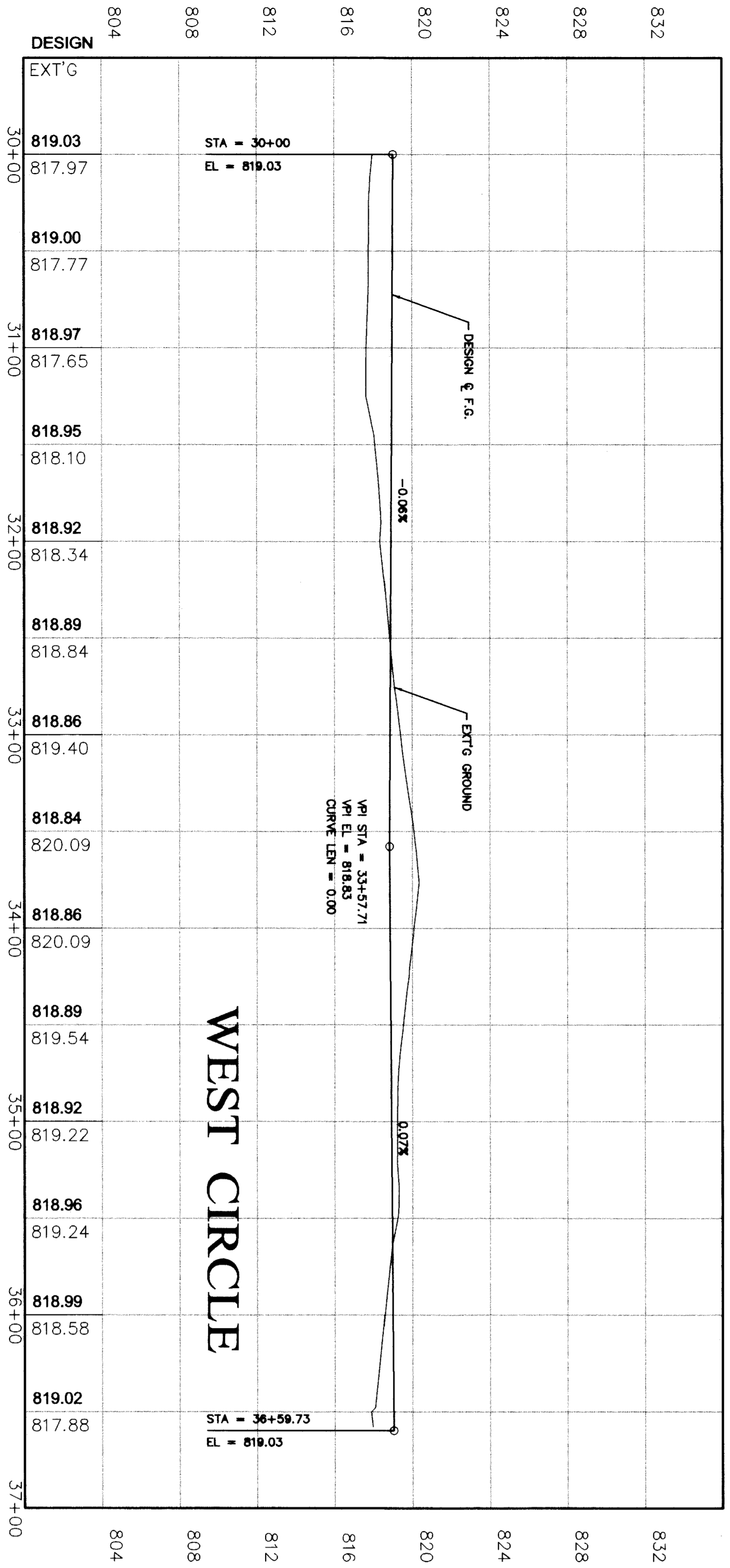
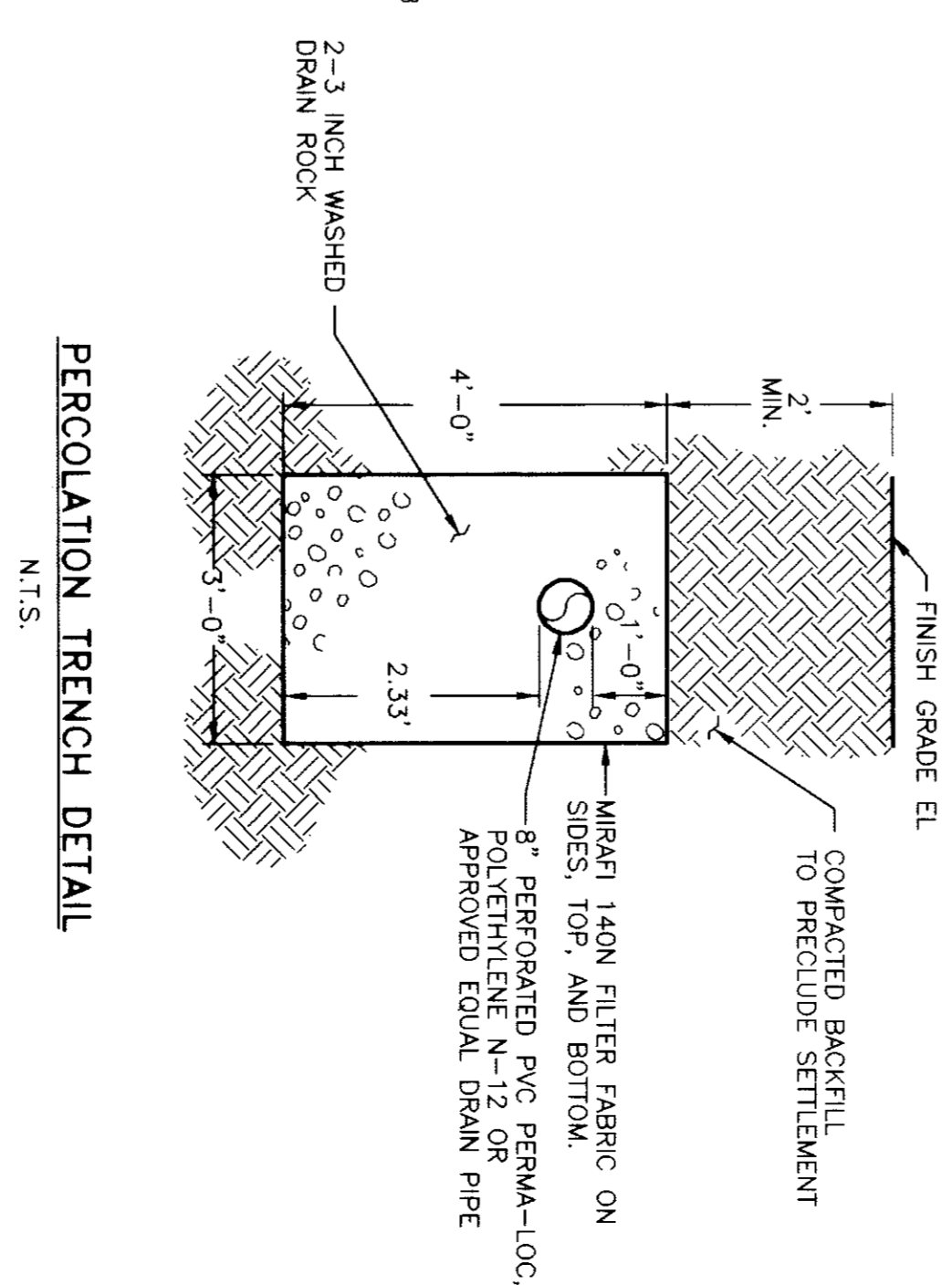
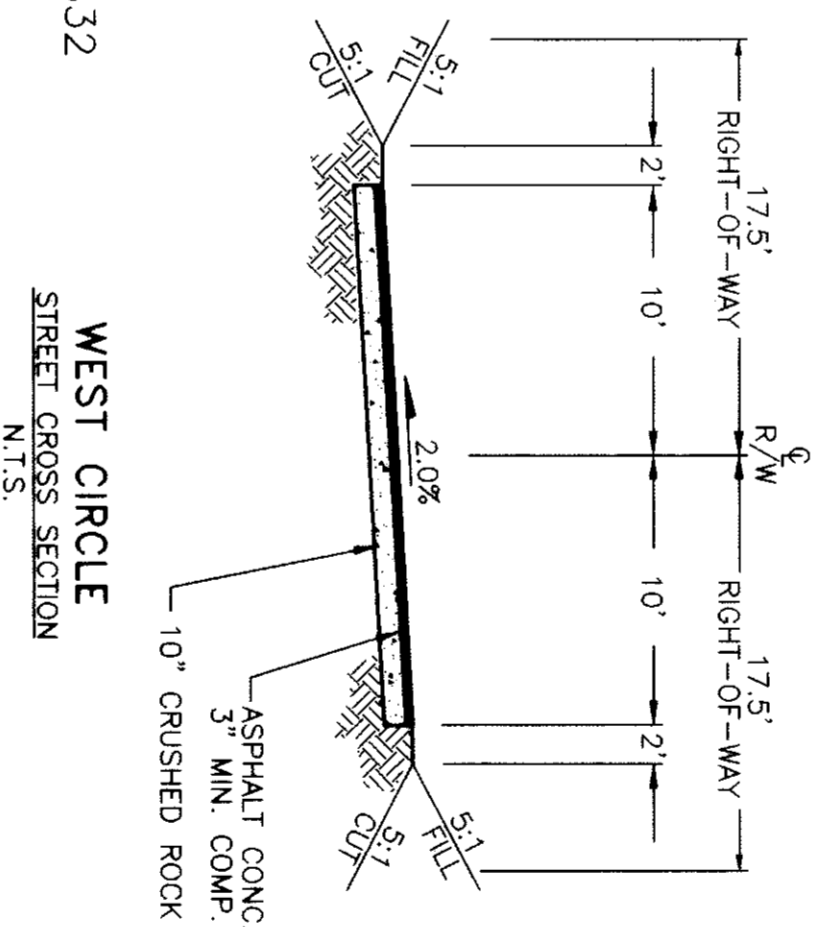
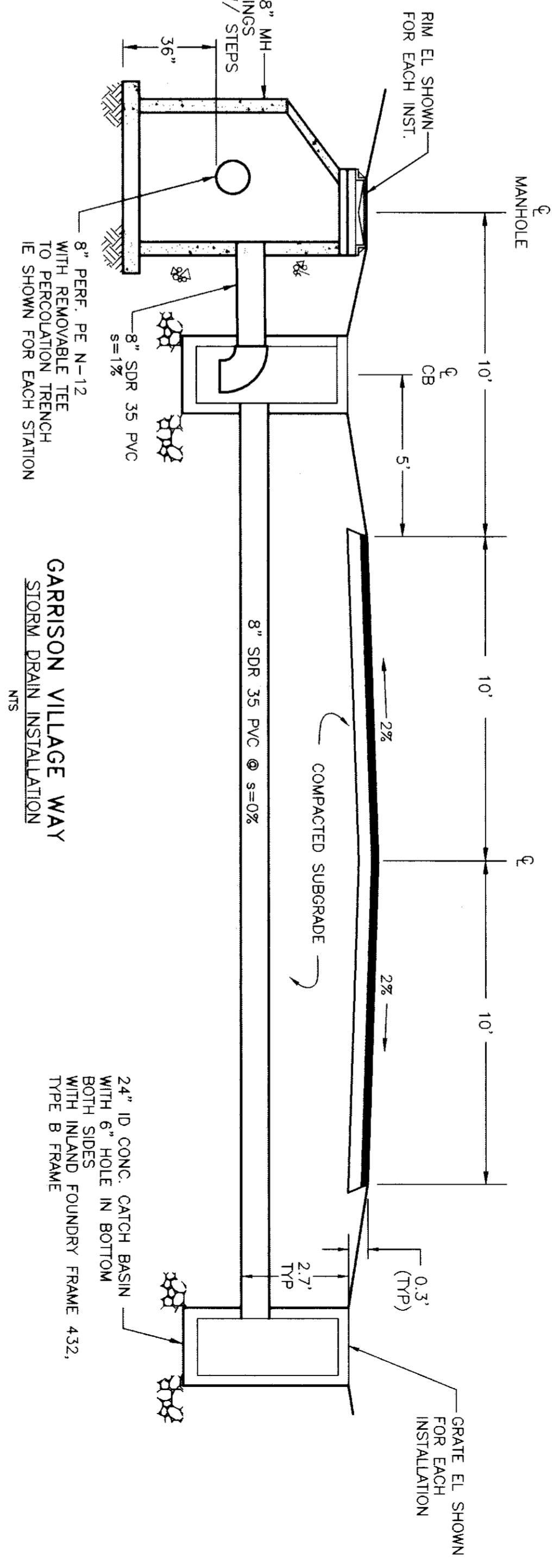

# WEST CIRCLE

SCALES:  
1" = 40' HOR  
1" = 4' VER

rcp01002.dwg

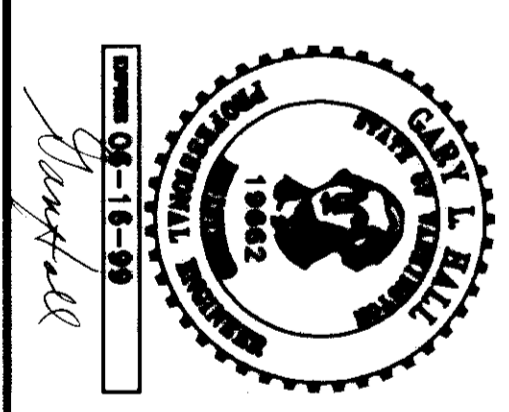

DATE: 11-19-98  
DRAWN BY: MA  
DWG. NO.: 061-0031

SHEET 4 OF 5  
CALL BEFORE YOU DIG (800) 332-4344  
**VALLEY DEVELOPMENT**  
GARRISON VILLAGE WAY EXTENSION  
PIP WEST CIRCLE

**HALL ENGINEERING ASSOCIATES**  
10 SOUTH ALBURN • KENNEDY, MA 01936  
(508) 362-2200 • FAX (508) 366-2897

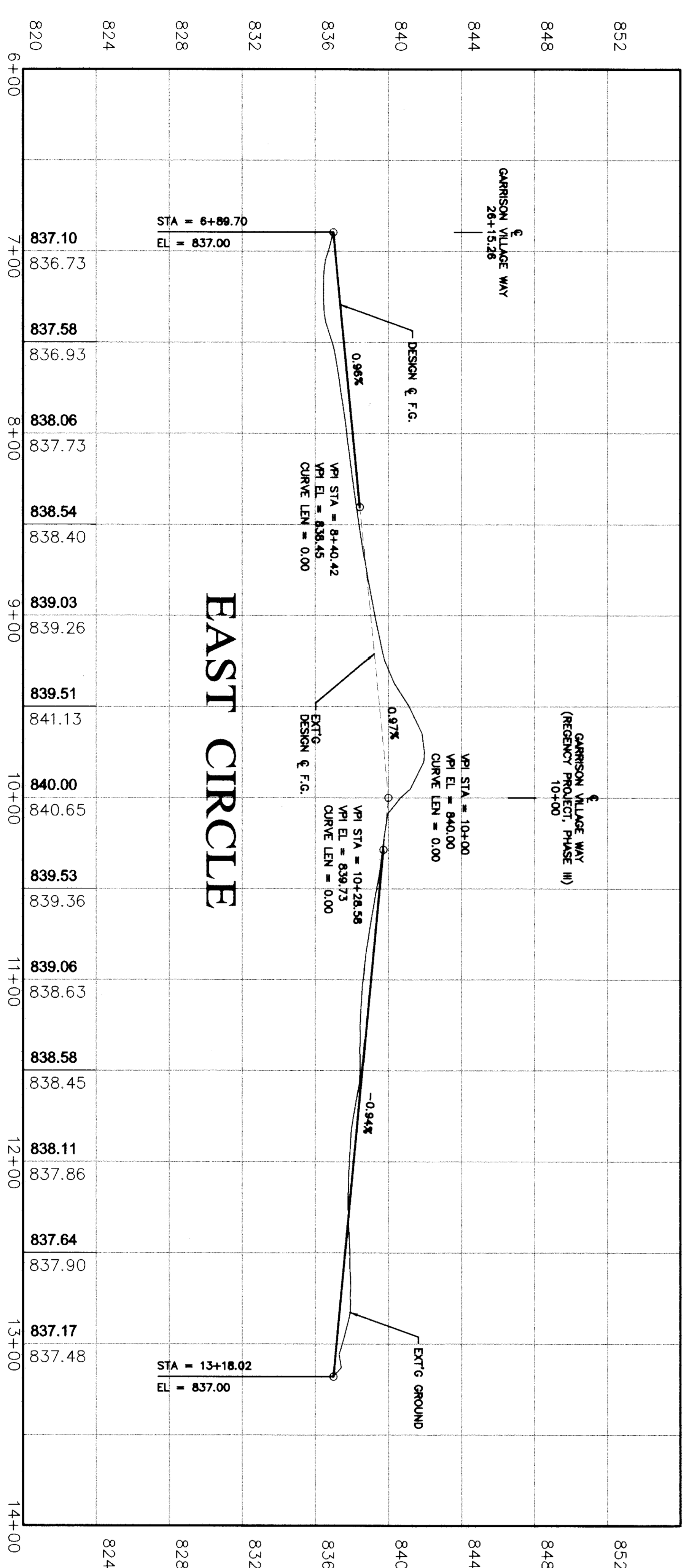
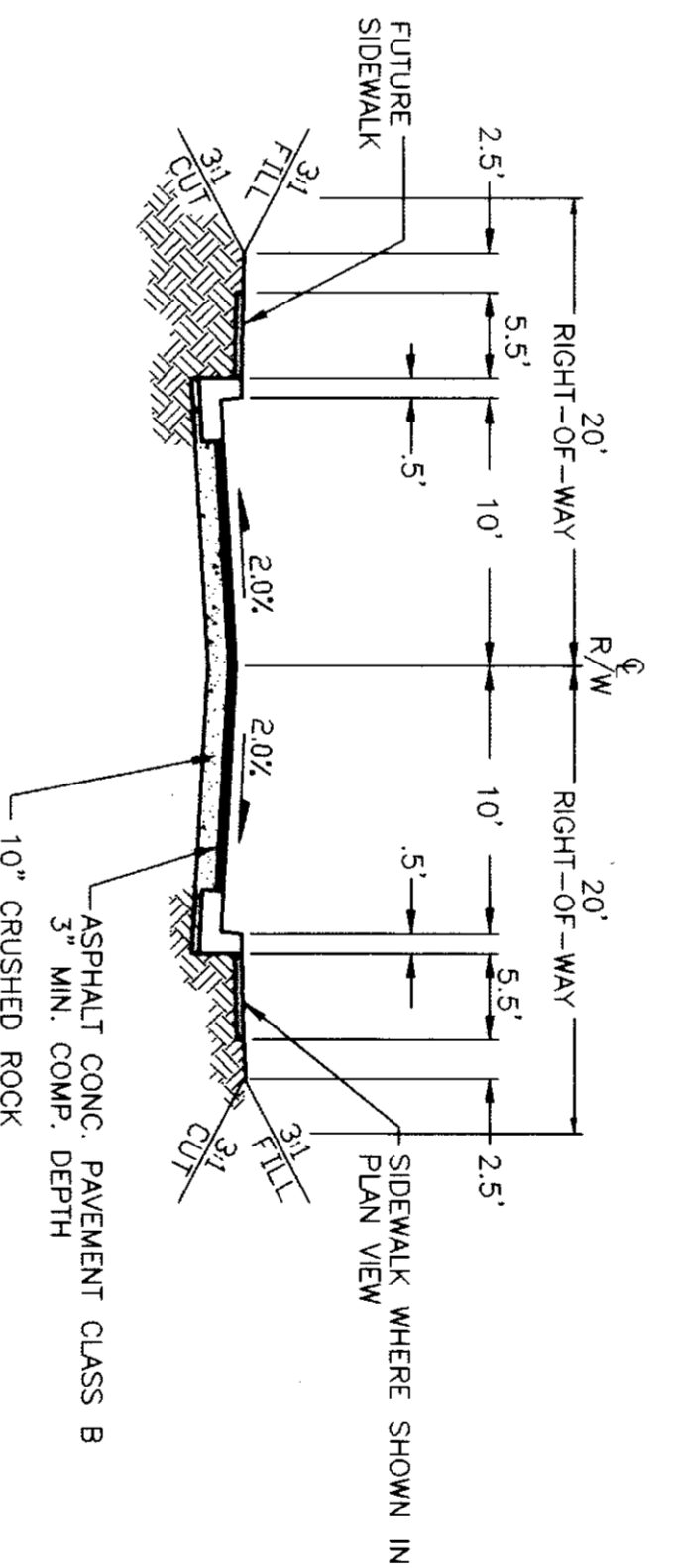
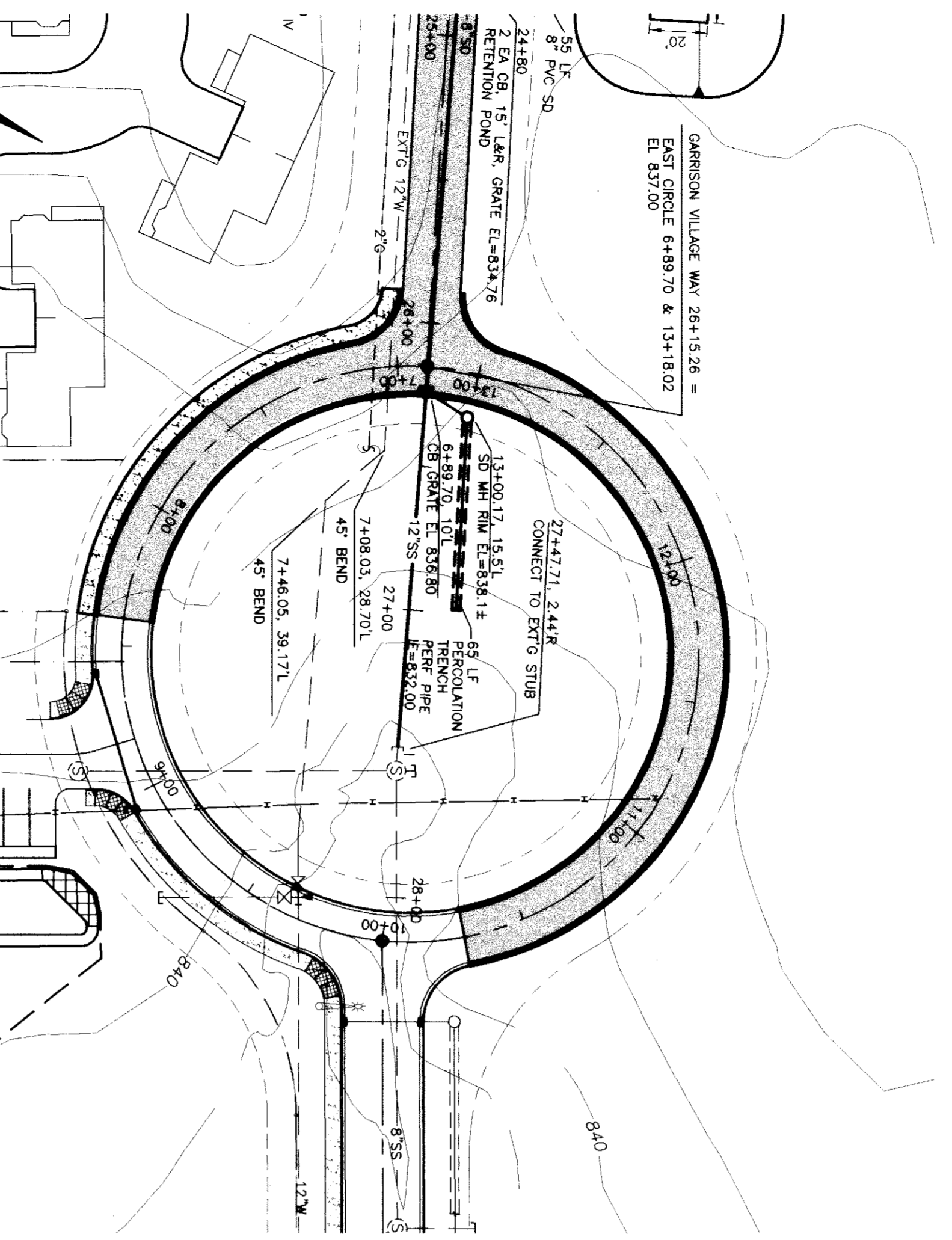

rs01003.dwg

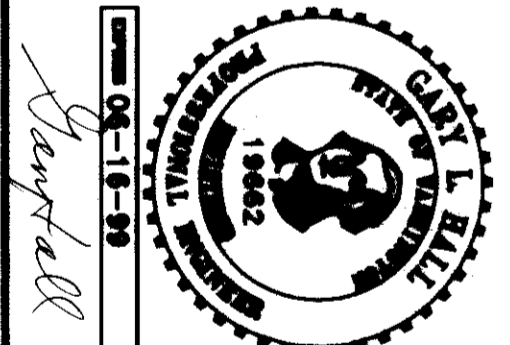

DATE: 11-19-98  
DRAWN BY: M  
DWG. NO: 061-0032

SHEET 5 OF 5  
CALL BEFORE YOU DIG (800) 352-4344

VALLEY DEVELOPMENT  
GARRISON VILLAGE WAY EXTENSION  
PIP EAST CIRCLE

HALL ENGINEERING ASSOCIATES  
10 SOUTH ALBEMARLE KENNESWICK, VA 20136  
(509) 362-2200 FAX (509) 366-2897